

AYANA

HEIGHTS SEAVIEW RESIDENCES

UNIT	SIZE	TYPE	ORIGINAL PRICE	DISCOUNT PRICE
E-108	43.95	STUDIO PLUS	6,969,282	4,840,103
E-109	43.95	STUDIO PLUS	6,967,593	4,845,135
E-110	43.95	STUDIO PLUS	6,876,840	4,785,752
E-112	43.95	STUDIO PLUS	6,863,572	4,783,842
E-113	43.95	STUDIO PLUS	7,192,133	5,016,914



*No discount for special price rooms, no free furniture package

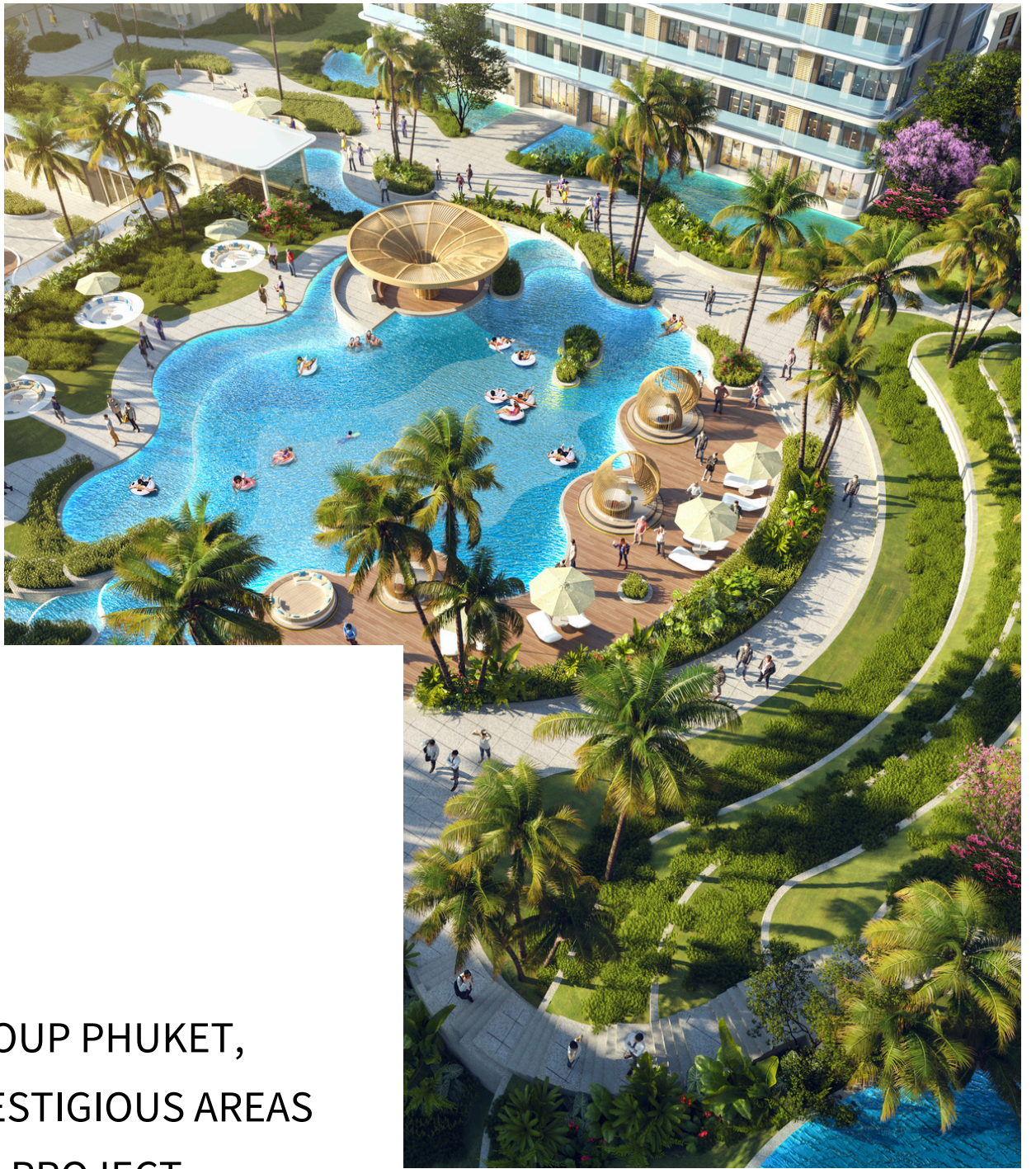

AYANA HEIGHTS

— IS A LUXURY PROJECT BY T.H GROUP PHUKET, LOCATED IN ONE OF THE MOST PRESTIGIOUS AREAS OF PHUKET, ON LAYAN BEACH. THE PROJECT COVERS 49,600 SQ. M. AND OFFERS ELEGANT APARTMENTS, VILLAS, AND TOWNHOUSES. AT THE HEART OF THE COMPLEX IS AYANA PARK, A BEAUTIFUL 8,000 SQ. M. GREEN SPACE. WITH ITS STUNNING LANDSCAPE, CASCADING POOLS, AND A SCENIC WATERFALL, IT CREATES A PEACEFUL AND ELEGANT ATMOSPHERE WHERE NATURE AND LUXURY COME TOGETHER



AYANA HEIGHTS

LOCATED IN A PRESTIGIOUS AREA OF PHUKET, OFFERING
EASY ACCESS TO THE ISLAND’S TOP DESTINATIONS

- LAYAN BEACH— 3 MIN.
- SUNSHINE BEACH RESORT — 3 MIN.
- LAGUNA PHUKET & LAGUNA GOLF — 5 MIN.
- BOAT AVENUE & PORTO DE PHUKET — 10 MIN.
- BLUE TREE & NAI THON BEACH — 15 MIN.
- HORSE RIDING CLUB, TENNIS COURT, ESSENTO SPA — 1 MIN.
- PHUKET INTERNATIONAL AIRPORT — 25 MIN.

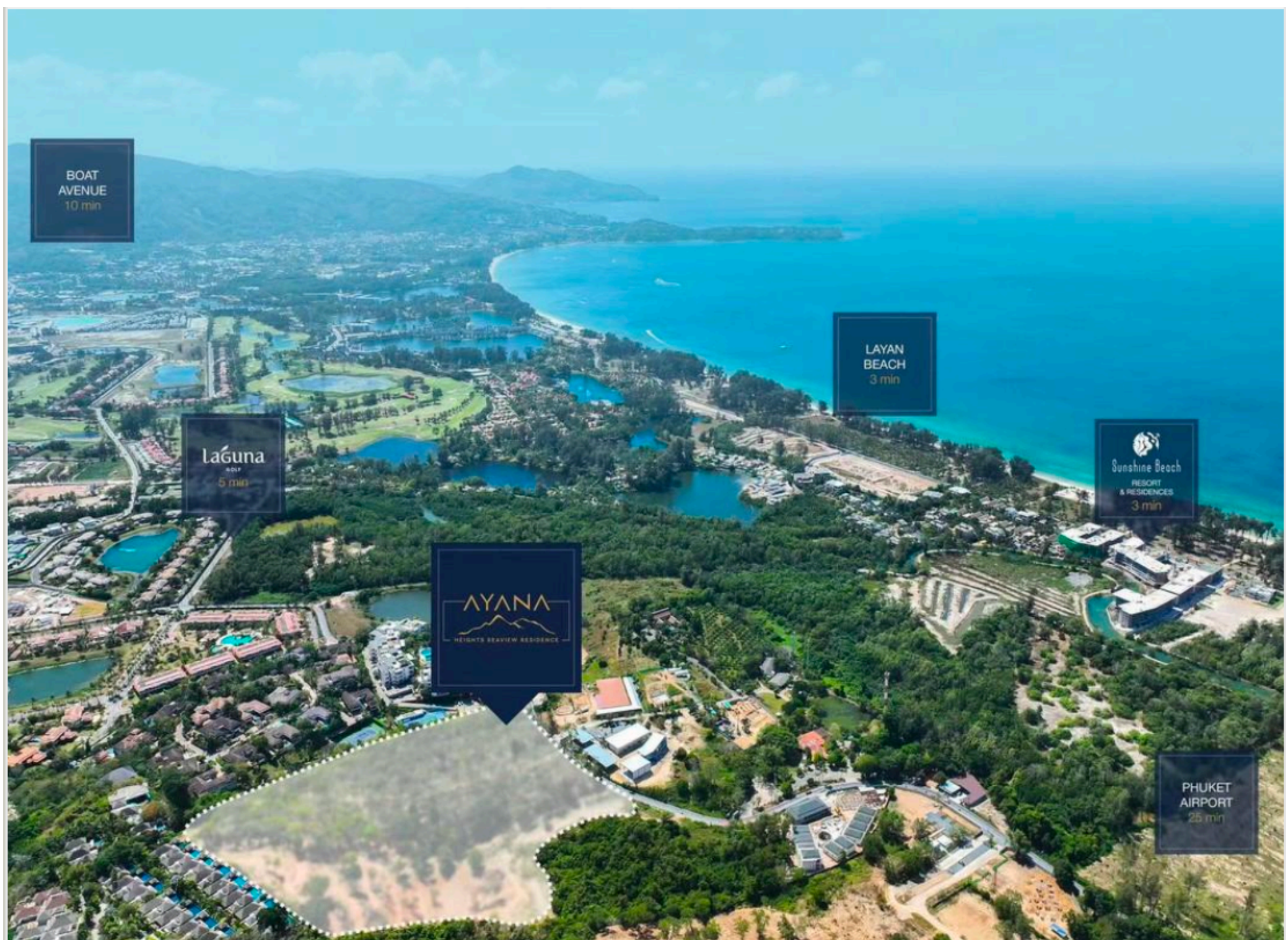

A PLACE WHERE NATURE AND CITY
COMFORTS COME TOGETHER

8 RESIDENTIAL BUILDINGS - 543 UNITS AREA
FROM 43.42 SQ.M. TO 112.89 SQ.M. 8000 SQ.M.
AYANA PARK WITH A POOL WATERFALLS,
SWIMMING POOLS AND PARK AREA



- PROJECT NAME: AYANA HEIGHTS SEA VIEW RESIDENCES
- DEVELOPER: T.H GROUP PHUKET CO.,LTD
- LOCATION: LAYAN, PHUKET
- OWNERSHIP TYPE: LEASEHOLD AND FREEHOLD
- RESIDENCE TYPES: APARTMENTS, TOWNHOUSES, VILLAS SERVICE
- FEE: 60 BAHT/SQ.M.
- SINKING FUND: 1 ANNUAL PAYMENT IN ADVANCE 800 BAHT/SQ.M. PAYMENT 1 TIME
- COMPLETION DATE: Q2 2027

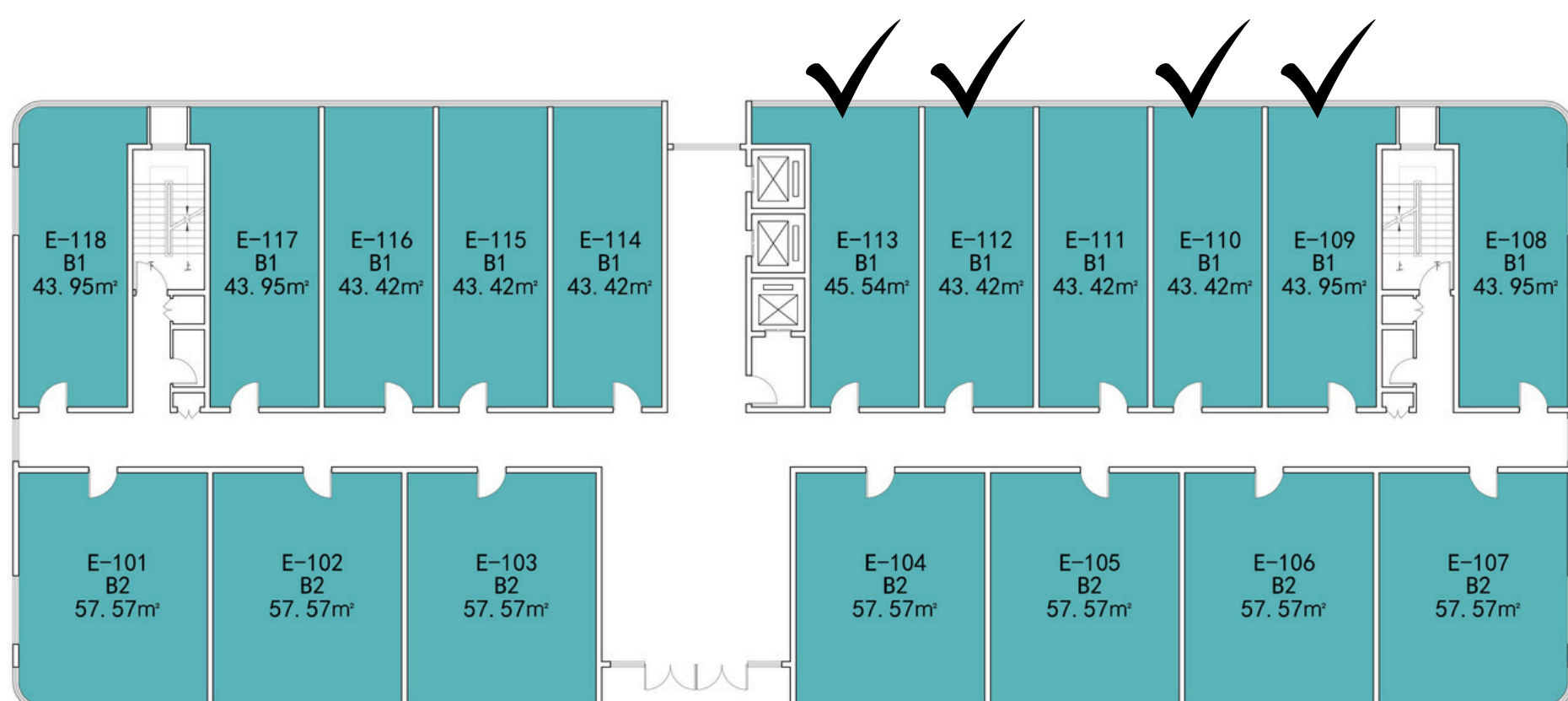



PAYMENT PLAN

- Deposit 100,000 THB
- First Payment 35% (within 30 days after signing the contract)
- Second Payment 20% (completion of foundation)
- Third Payment 30% (completion of main structure)
- Fourth Payment 15% (acceptance)
- CAM Fee 60 thb/sqm/month
- Sinking Fund 800 thb/sqm
- Project Completion Q2 2027